

Model 400

Models 900 & 1100

Models 1800 & 3000

Models 4500 & 5500

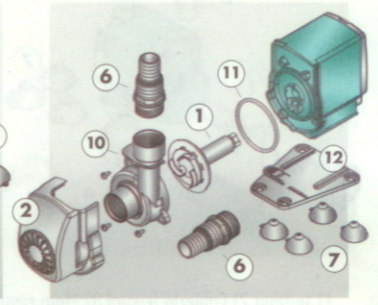
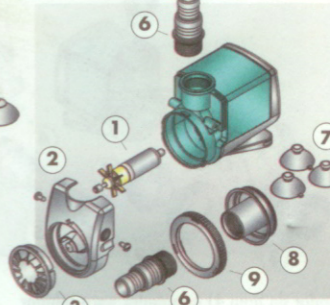
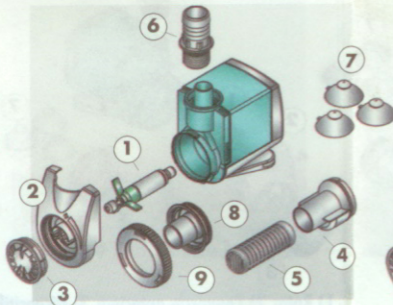
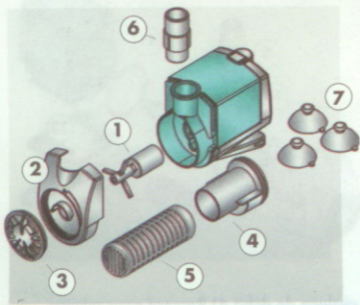

- 1) Impeller 2) Front Cover 3) Flow Adjustment Plate 4) Strainer Adapter 5) Strainer 6) Hose Barb 7) Suction Cups
8) Inline Intake 9) Locknut 10) Impeller Housing with screws 11) O-Ring 12) Mounting Bracket

- SETUP OPTIONS -

Option A Submerged Under-Water Use (All Models)

Model 400	Models 900 & 1100	Models 1800 & 3000	Models 4500 & 5500	Set Water Flow (Models 400, 900, 1100, 1800 & 3000 only)	Sump System Setup	Water Circulation Setup

1. Each Sump Pump is preassembled for this Setup Option. 2. (Optional) Adjust water flow using the Flow Adjustment Plate (Models 400, 900, 1100, 1800 & 3000 only). 3. Pick pump placement options Sump System or Water Circulation. 4. After pump placement continue on to **Start Your Pump**.

(Options B and C) Installing Accessories - Follow These Steps First

1. Remove front cover.

Models 1800 & 3000
Remove Screws

2. Pop the Standard Flow Adjustment out with a screwdriver. (Models 400, 900, 1100, 1800 and 3000 ONLY)

NOTE: There are two setup options with accessory use: **Submerged Under-Water** use, Continue on to **Setup Option B**. And/or **External Out-Of-Water** use, Continue on to **Setup Option C**.

Option B Submerged Under-Water Use - With Strainer (Models 400/900/1100/4500/5500)

Model 400	Models 900 & 1100	Models 4500 & 5500	Sump System Setup	Water Circulation Setup

1. (Models 400, 900, and 1100) With the Flow Adjustment Plate removed, reinstall Front Cover. Install Strainer Adapter & Strainer. (Optional) Install Sponge (NOT Included). Rotate Strainer Adapter to adjust water flow. (Models 4500 & 5500) Install extra Hose Barb. 2. Pick pump placement options Sump System or Water Circulation. 3. Continue on to **Start Your Pump**.

Option C External Out-Of-Water Use (Models 900/1100/1800/3000/4500/5500)

Models 900 & 1100	Models 1800 & 3000	Models 4500 & 5500	Sump System Setup

NOTE: Model 400 can NOT be used for External use.

1. Remove Front Cover. 2. (Models 900,1100,1800 and 3000) Install Inline Intake and secure with Locknut. (Models 1800 and 3000) Install extra Hose Barb. (Models 4500 and 5500) Rotate (optional) Impeller Housing and install with extra Hose Barb. 3. Place pump in Sump System as shown. 4. Continue on to **Start Your Pump**.

Start Your Pump (All Models)