

# MAXI-JET<sup>®</sup> SUBMERSIBLE UTILITY PUMPS



## MODELS:

NJ400, NJ900, NJ1100, NJ1800,  
NJ3000, NJ4500 and NJ5500

### PUMP FLOW

MODEL	WATTAGE	AMPS	MAX FLOW GPH	MAX FLOW L/H	MAX HEAD HEIGHT INCHES
400	7	0.08	106	401	26
900	10	0.12	247	935	50
1100	21	0.32	294	1113	69
1800	38	0.84	474	1794	87
3000	58	0.96	775	2933	110
4500	58	1.25	1175	4448	122
5500	75	1.30	1385	5242	157

**LIMITED WARRANTY** Within three years from the date of original purchase, Marineland Aquarium Products will repair or replace, at its option, any MAXI-JET Utility Pump which is deemed defective in workmanship or materials. Please return the unit, together with proof of date of purchase: Call (800) 322-1266 for return authorization and shipping address. Damage or injuries resulting from negligence or misuse are not covered by this warranty. Incidental or consequential damages are specifically excluded. \* This warranty gives you specific legal rights. You may also have other rights which vary from state to state. \* Because some states do not allow the exclusion of incidental or consequential damages, this exclusion may not apply to you.

Questions or Missing Parts: Call Customer Service a  
(800) 322-1266 (M-F 7:30 am - 5:30 pm Eastern Time)

**MARINELAND**  
www.marineland.com

06/08 AQ1222  
MADE IN ITALY  
17.80.00

## IMPORTANT SAFEGUARDS

**WARNING:** To guard against injury, basic safety precautions should be observed, including the following.

## READ AND FOLLOW ALL SAFETY INSTRUCTIONS

**DANGER:** To avoid possible electric shock, special care should be taken in the use of aquarium equipment. For each of the following situations, do not attempt repairs yourself. Return the appliance to an authorized service facility for service or discard the appliance.

1. **A.** If the appliance shows any sign of abnormal water leakage, immediately unplug from the power source.
- B.** Carefully examine the appliance after installation. It should not be plugged in if there is water on parts not intended to be wet.
- C.** Do not operate any appliance if it has a damaged cord or plug, or if it is malfunctioning or if it is dropped or damaged in any manner.
- D.** To avoid the possibility of the appliance plug or receptacle getting wet, position aquarium stand and tank to one side of a wall mounted receptacle to prevent water from dripping onto the receptacle or plug. A "drip loop", shown in the figure at right, should be arranged by the user for each cord connecting an aquarium appliance to a receptacle.

The "drip loop" is that part of the cord below the level of the receptacle or the connector, if an extension cord is used, to prevent water from traveling along the cord and coming in contact with the receptacle. If the plug or receptacle

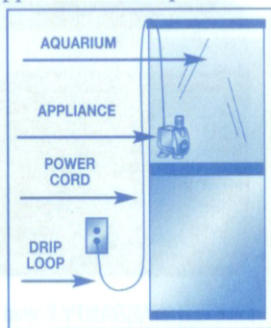

does get wet, DON'T unplug the cord. Disconnect the fuse or circuit breaker that supplies power to the appliance. Then unplug and examine for presence of water in the receptacle.

2. Close supervision is necessary when any appliance is used by or near children.
3. To avoid injury, do not contact moving parts or hot parts such as heaters, reflectors, lamp bulbs, etc.
4. Always unplug an appliance from an outlet when not in use, before putting on or taking off parts, and before cleaning. Never yank cord to pull plug from outlet. Grasp the plug and pull to disconnect.
5. Do not use an appliance for other than intended use. The use of attachments not recommended or sold by the appliance manufacturer may cause an unsafe condition.



- Do not install or store the appliance where it will be exposed to the weather or to temperatures below freezing.
- Make sure an appliance mounted on a tank is securely installed before operating it.
- Read and observe all the important notices on the appliance.
- If an extension cord is necessary, a cord with a proper rating should be used. A cord rated for less amperes or watts than the appliance rating may overheat. Care should be taken to arrange the cord so that it will not be tripped over or pulled.

## SAVE THESE INSTRUCTIONS

**WARNING:** Always unplug Utility Pump when inspecting or disassembling for any reason.

### Troubleshooting Guidelines

#### If pump stops working...

- Check impeller for obstruction.
- Make sure water level is not too low. Intake should be below water level in both internal and external applications.

#### If pump is free from obstructions and intake is below water level but pump is still not working...

- Thermal cut-off has been activated.
- Models NJ1100, NJ1800, NJ3000:** only unplug pump from electrical supply for approximately one hour. Then reconnect.
- Models NJ4500 and NJ5500:** unplug pump from electrical supply and reconnect.

### IMPORTANT ADDITIONAL SAFETY INSTRUCTIONS

- ALWAYS** check the voltage on the pump label to make sure that it corresponds to the main power supply.
- NEVER** repair or replace the Utility Pumps power cord. If it is damaged, replace the entire pump unit.
- The pump is not a toy.
- It must NOT be used by children without the supervision of an adult.

### For Optimum Pump Performance:

Remove front cover and clean Impeller & Impeller well monthly.

**Models 4500 and 5500:** Remove front cover and Impeller housing to clean Impeller & Impeller well monthly. To reassemble impeller assembly make sure that it is properly inserted in its seat (see special marks on impeller disk and body pump).

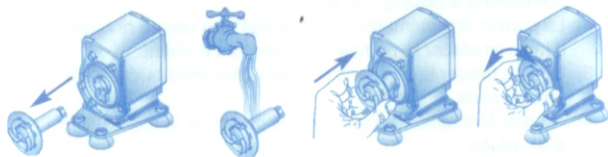

To replace the impeller assembly follow instructions provided with replacement part.

## Replacement Parts List Pieces detachees Piezas de repuesto

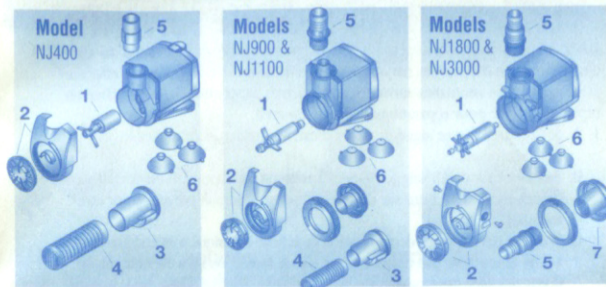

KEY	ITEMS	MODEL NUMBERS				
		NJ400	NJ900	NJ1100	NJ1800	NJ3000
1	Impeller	00.74.004	00.72.002	00.72.004	00.73.010	00.73.012
2	Front Cover & Plate Hose Barb Included	00.74.002	00.72.005		00.73.016 2 Screws Included	00.73.017 2 Screws Included
3	Strainer Adapter	00.74.001	00.72.006		N/A	N/A
4	Strainer	00.40.011 (2 Pcs)			N/A	N/A
5	Hose Barb	N/A	00.72.011		00.73.008	
6	Suction Cups	00.48.012 (3 Pcs)	00.40.001 (4 Pcs)		00.73.015 (3 Pcs)	
7	Inline Intake & Locknut	N/A	00.72.007		00.73.018	00.73.019

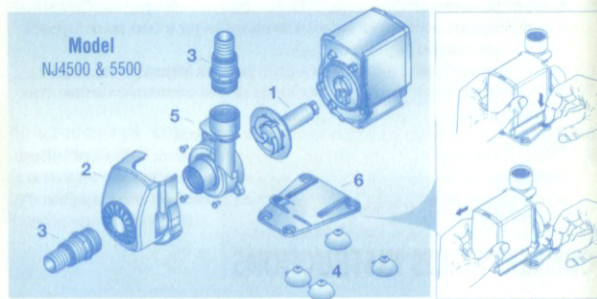

KEY	ITEMS	MODEL NUMBERS	
		NJ4500	NJ5500
1	Impeller	00.180.001	00.180.007
2	Front Cover	00.180.002	
3	Hose Barb (2 pack)	00.180.003	
4	Suction Cups (4 pack)	00.180.004	
5	Impeller Housing (With Screws)	00.180.005	
6	Mounting Bracket	00.180.006	